

JR 12/24

4768-124

MACHINE

NEBITYPE

NTC

SOC. NEBITYPE - TORINO

CATALOGUE INDEX

Base and Job stand	2
Elevator slide plate and ejector assembly	3
Elevator slide and stick carrier	4
Clamping mechanism	5
Pot assembly	6
Pump mechanism	7
Trimming knife slide and gripper assembly	8
Galley mechanism	9
Cam lever connecting links	10
Cam banal	11
Power transmission torque limiter and cams	12
Cam levers	13
Pump safety and release mechanism	14
Coolant system	15
Electrical equipment	16
Automatic metal feeder	17
Metal feeder box	18
Mold	19
Comboring stick	20
Tools	21

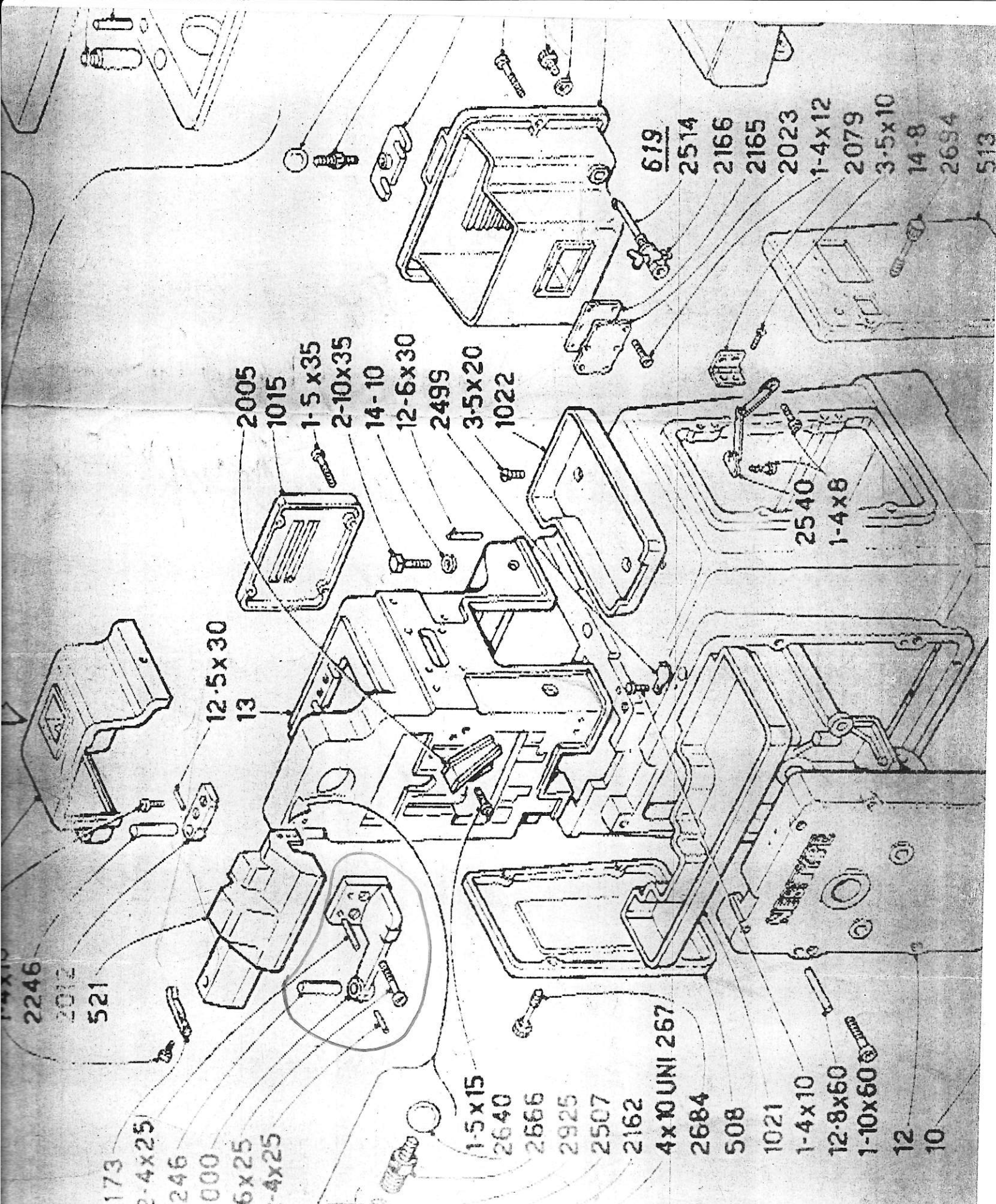

**CAIN'S SER**

P.O. BOX 686, 188 CU  
PALMERSTON  
TELEPHONE & FAX:



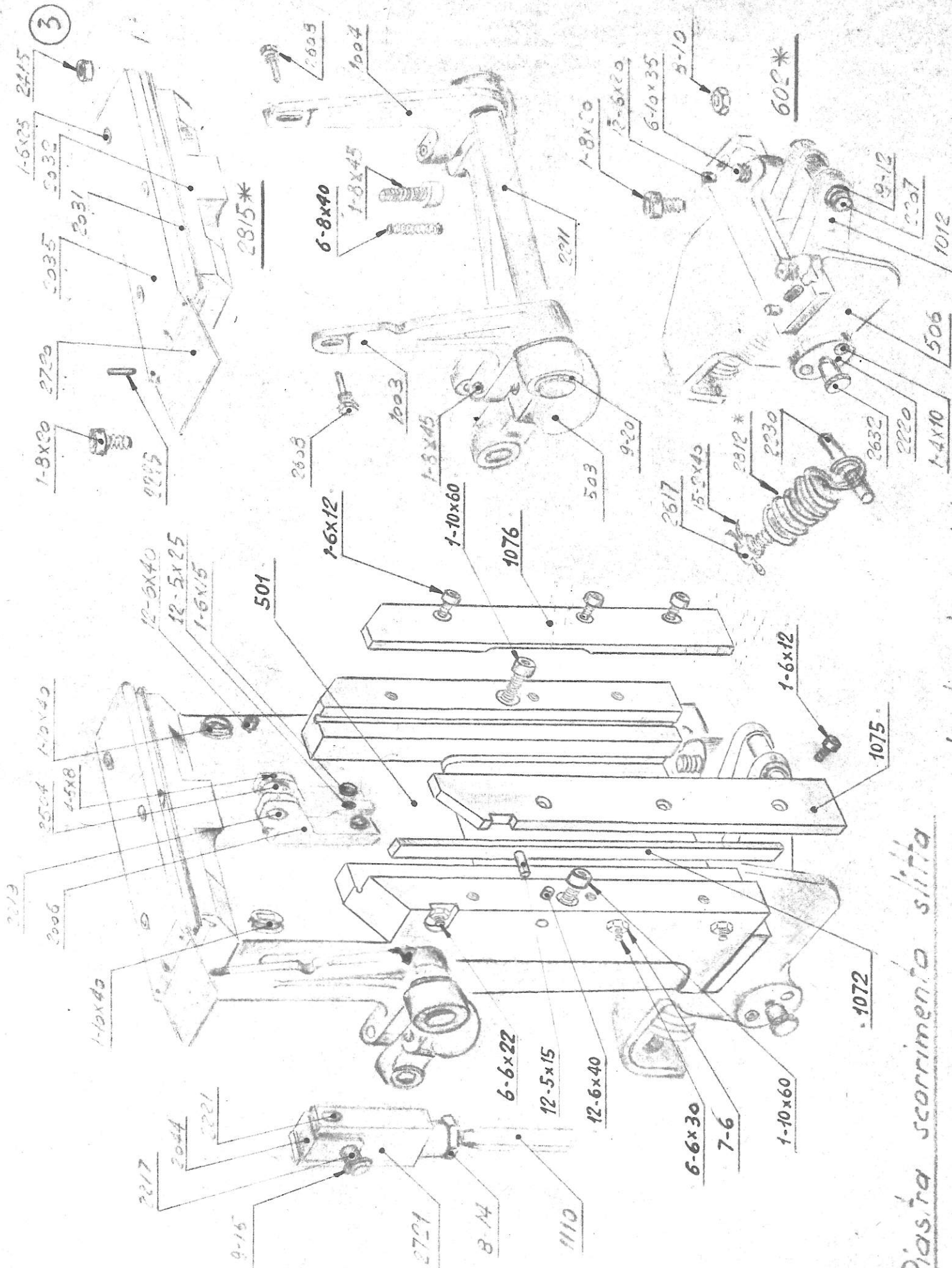

*Piastra scorrimento slitta*  
*Movimento sbloccata - Elevator slide blade and ejector assembly*



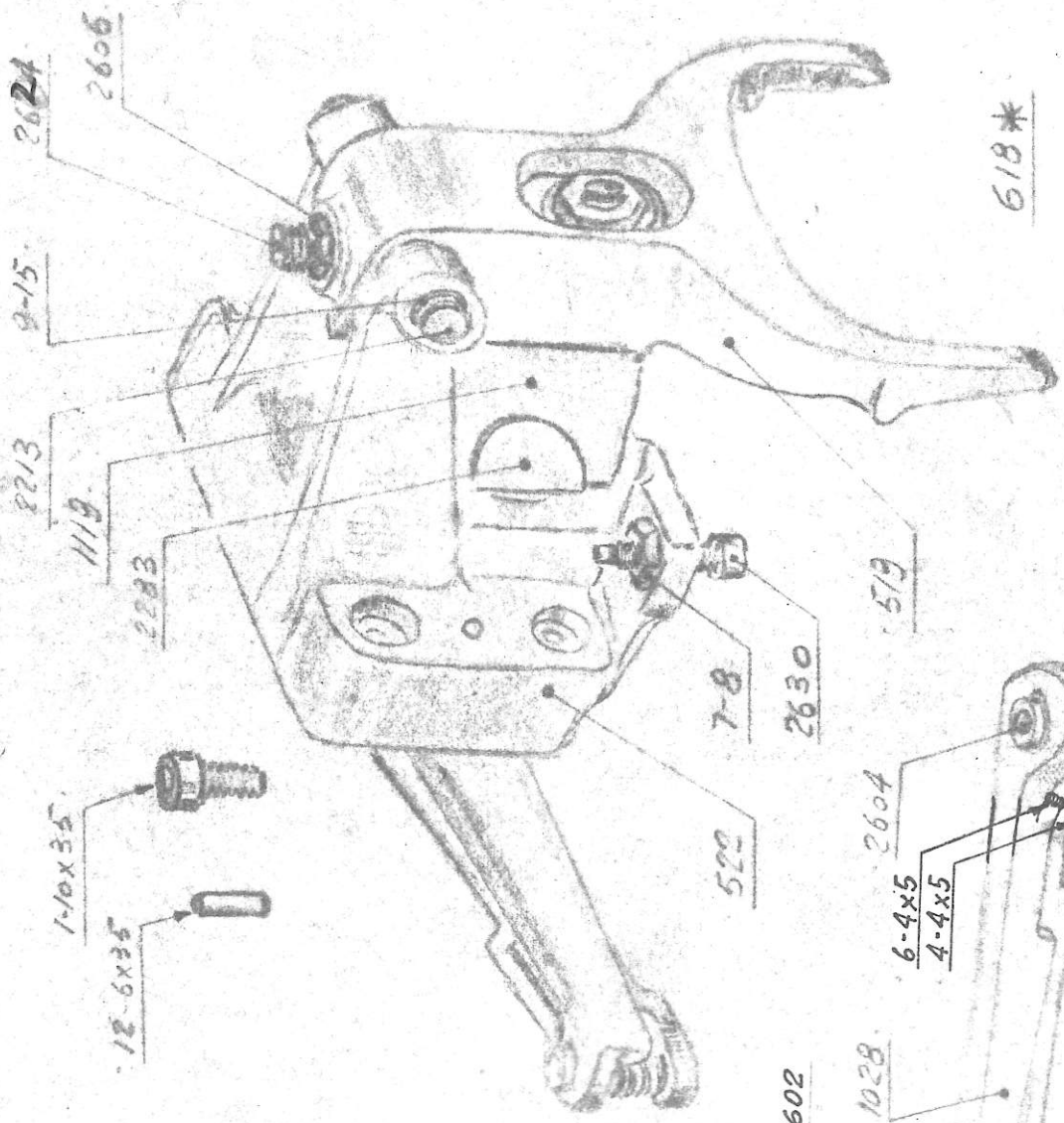

Ros. A 15 UNI 1751

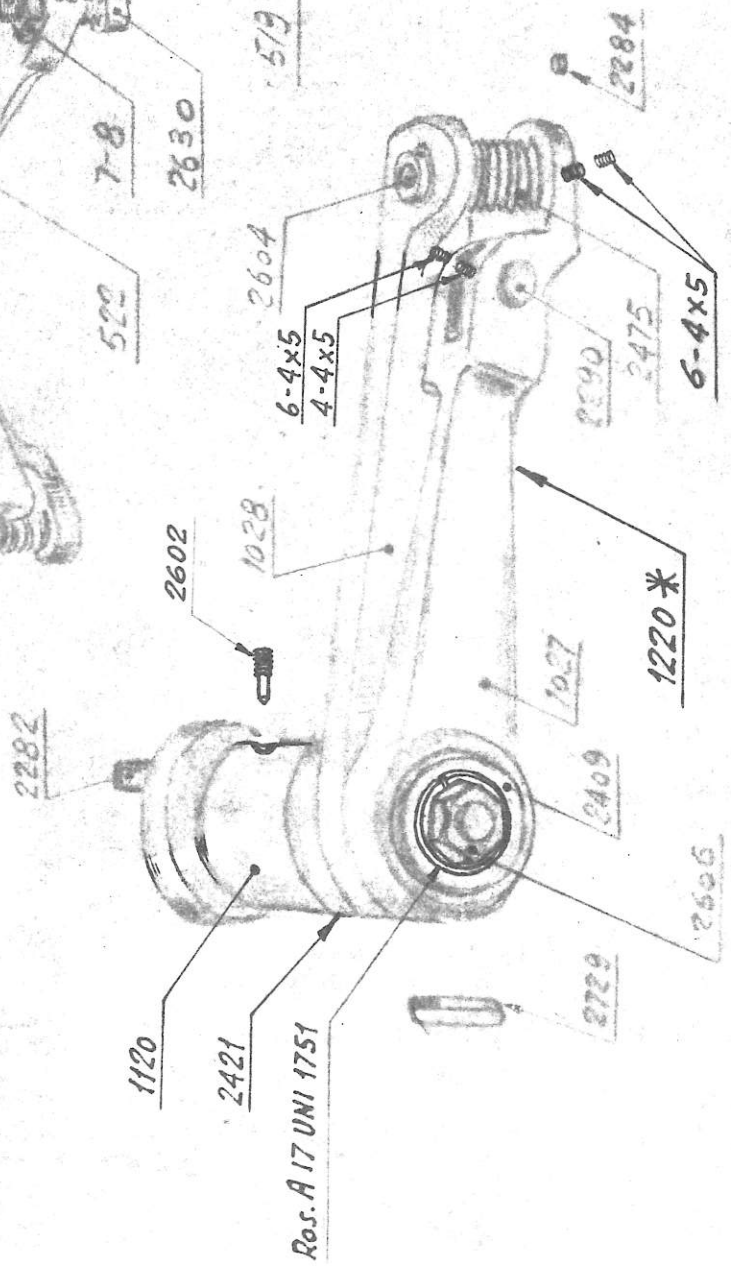

Ros. A 17 UNI 1751

Bloccaggio - Clamping mechanism

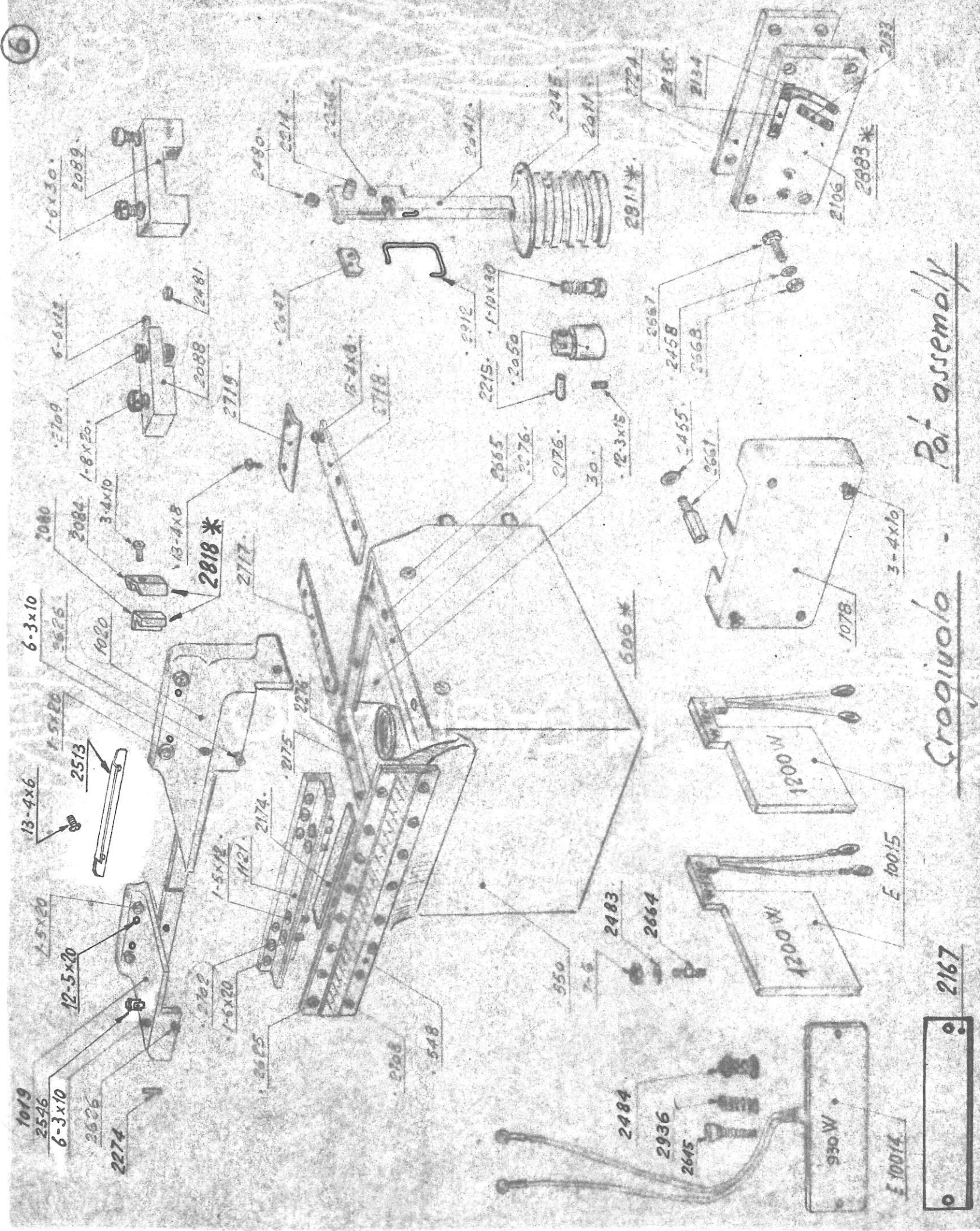

Pol assembly  
Crogiuolo

2167

7

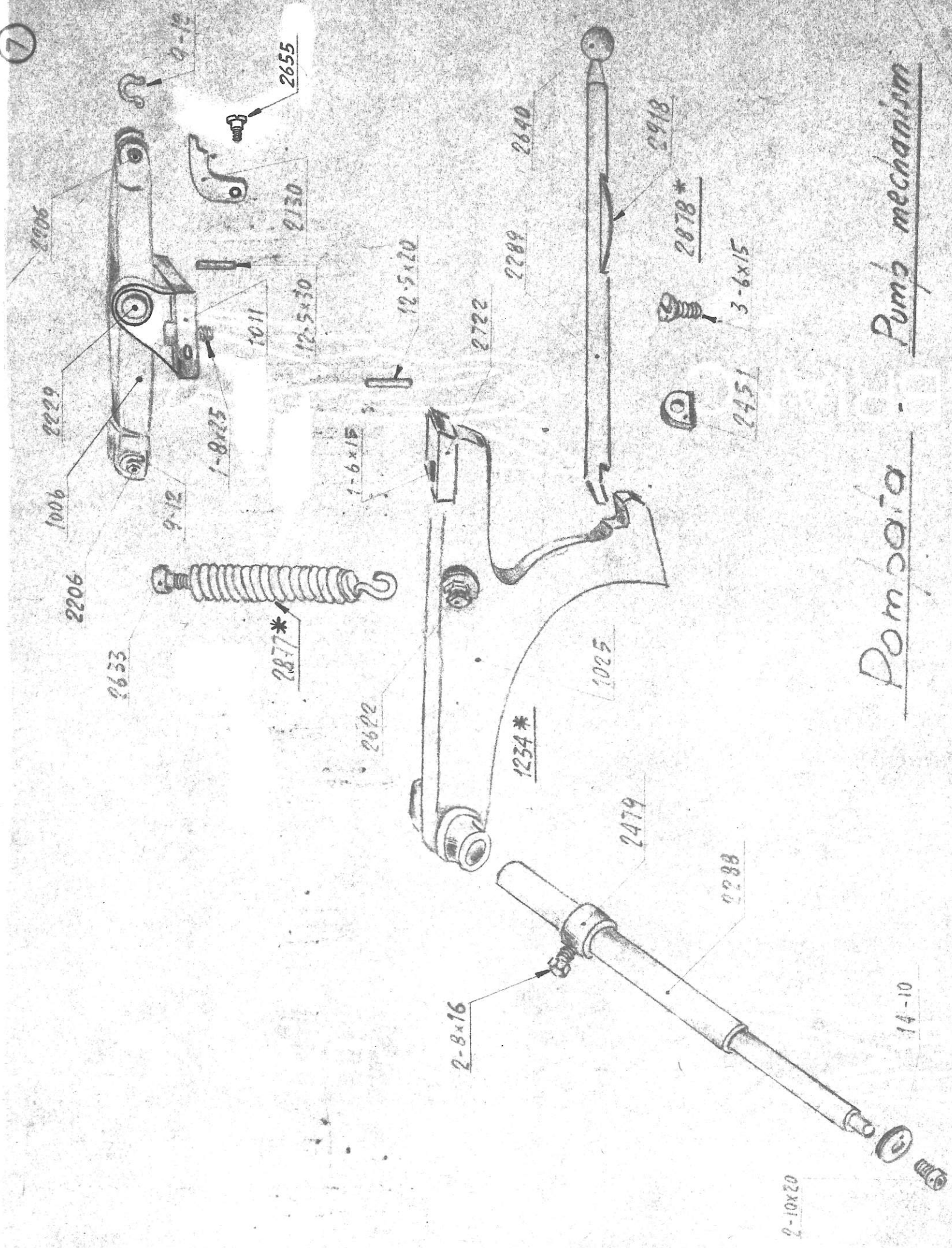

Pompa - Pump mechanism

2-10x20





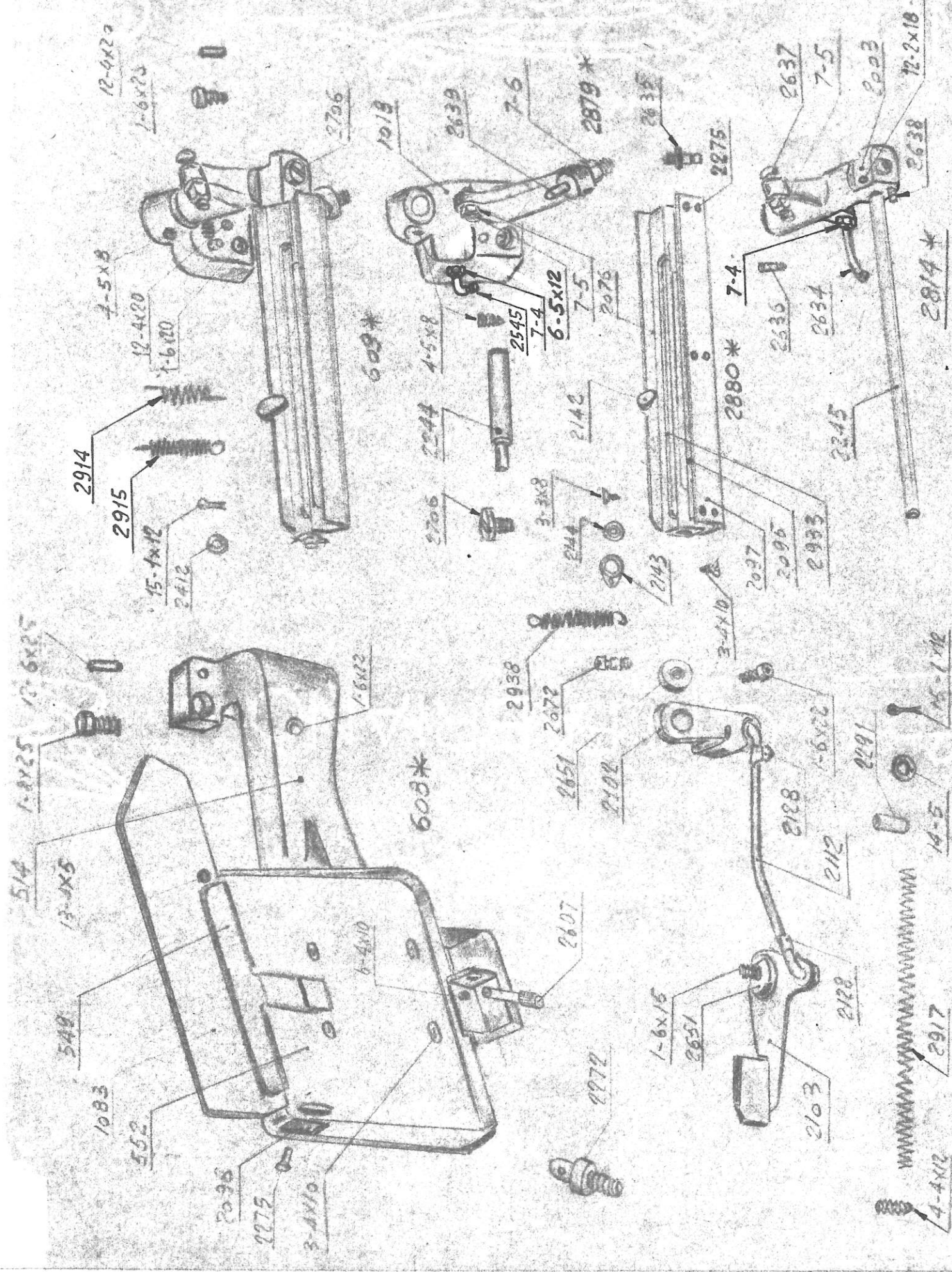

Scivolo e variatore - Galley mechanism



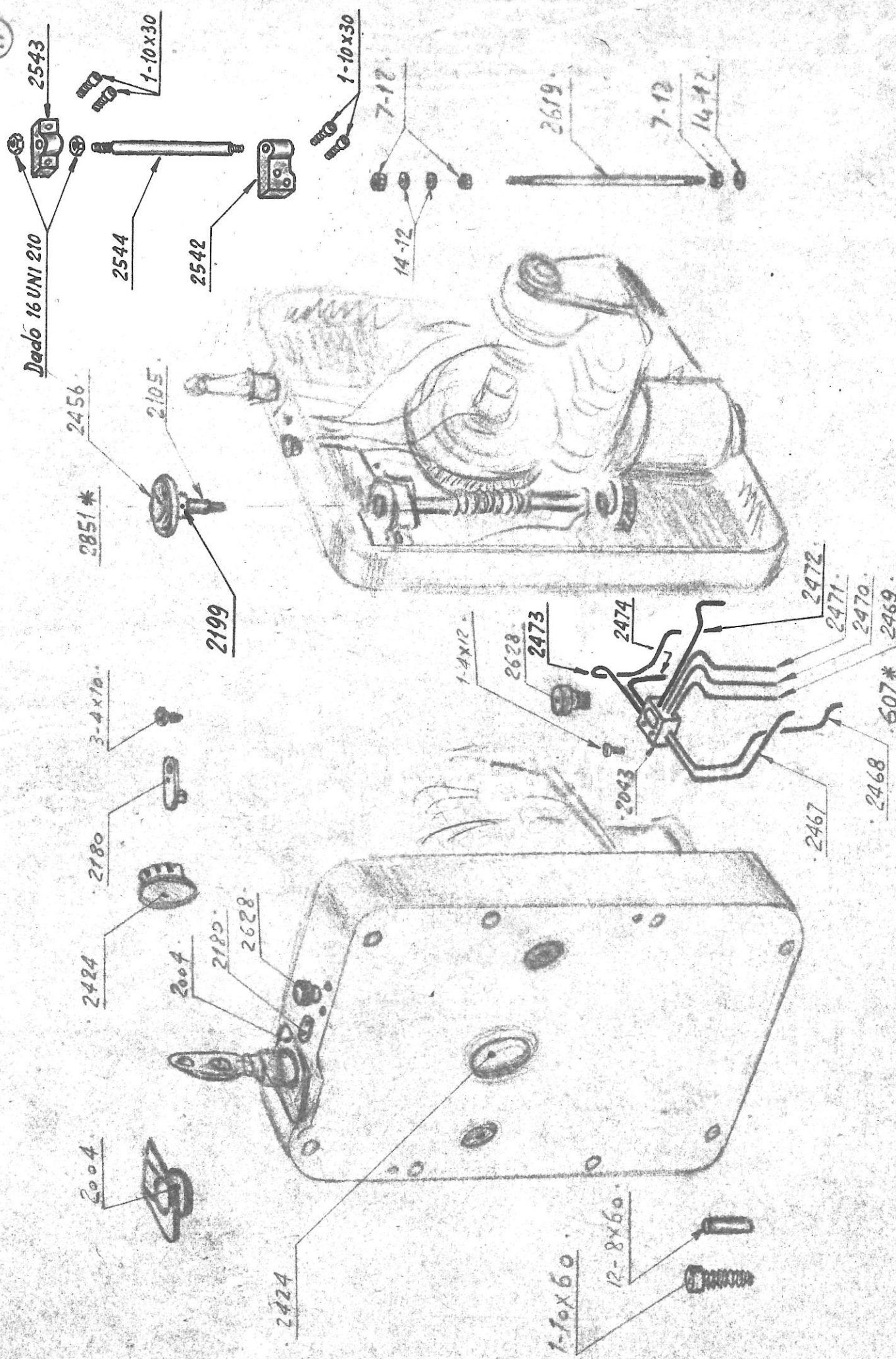

Coberchio eccentrici - Cam panel



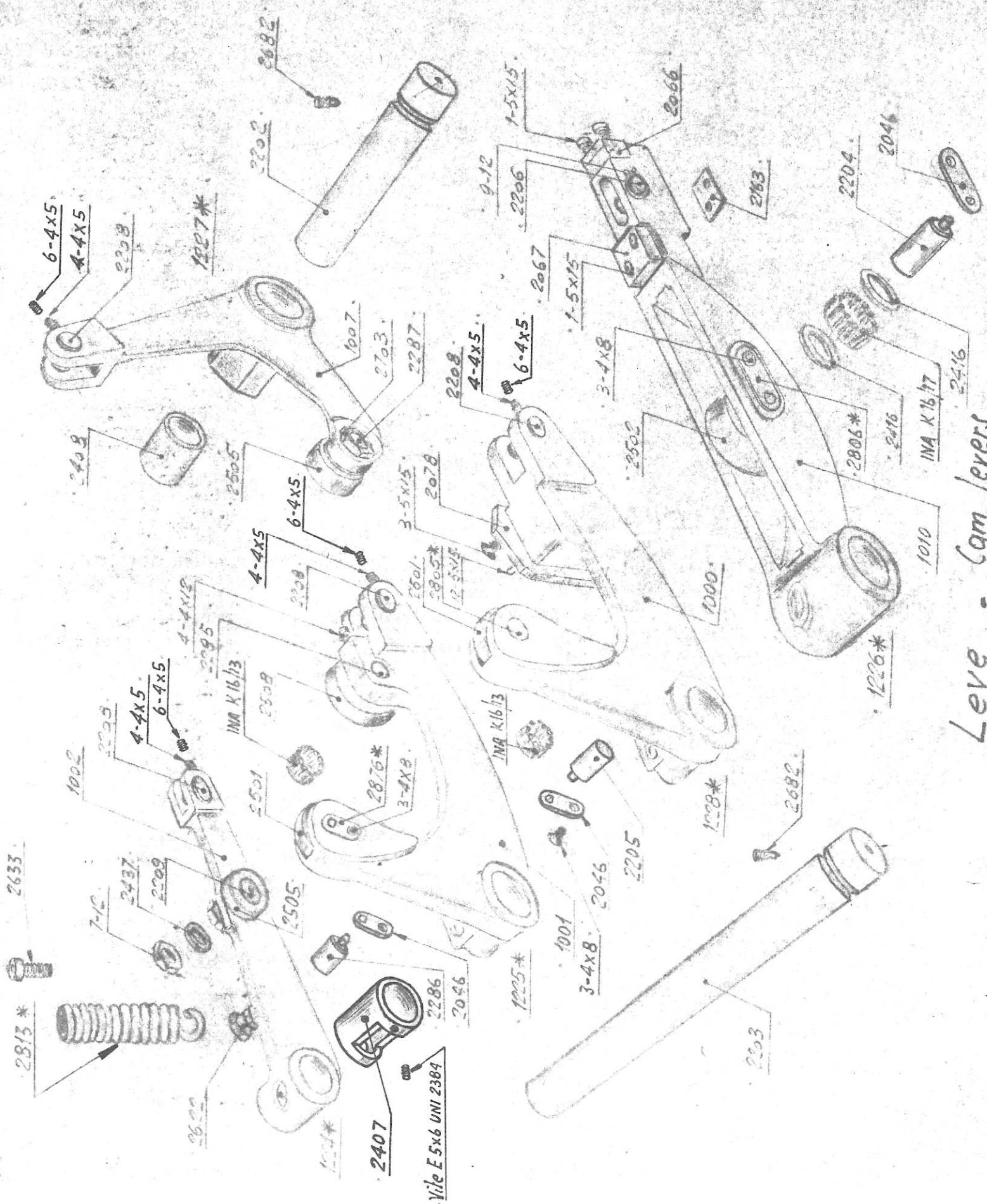

Lever - Cam levers









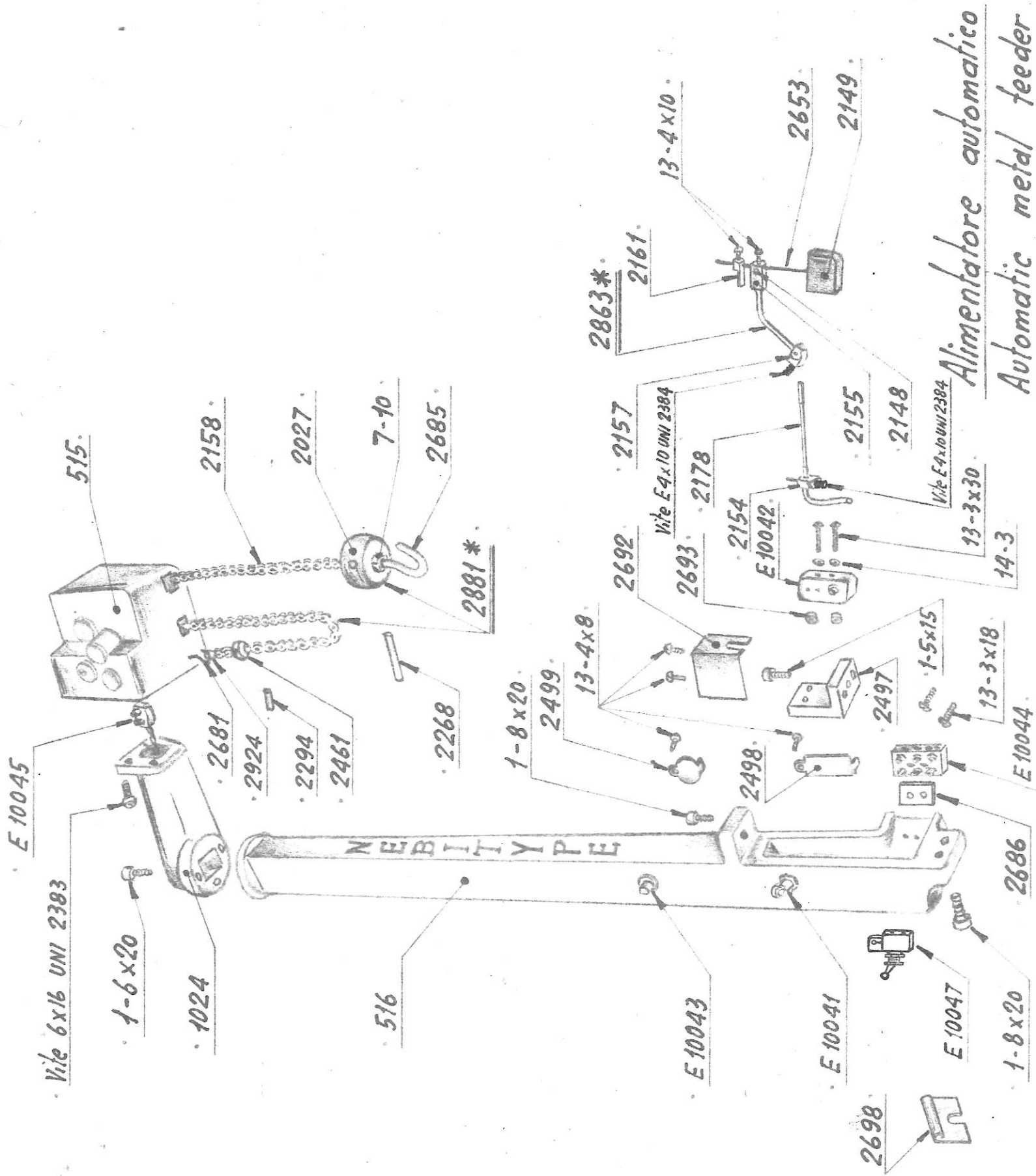

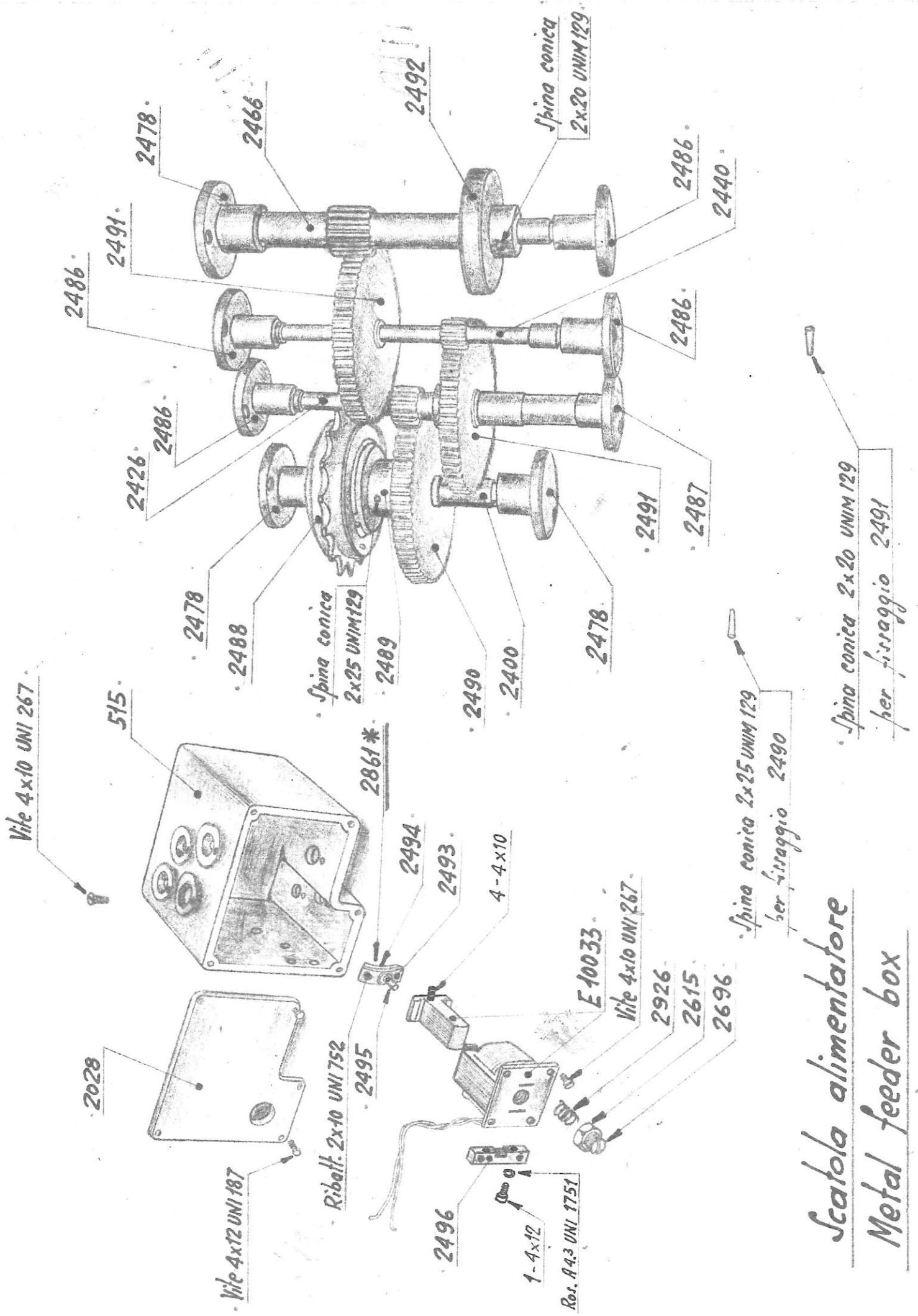

Scatola alimentatore  
Metal feeder box

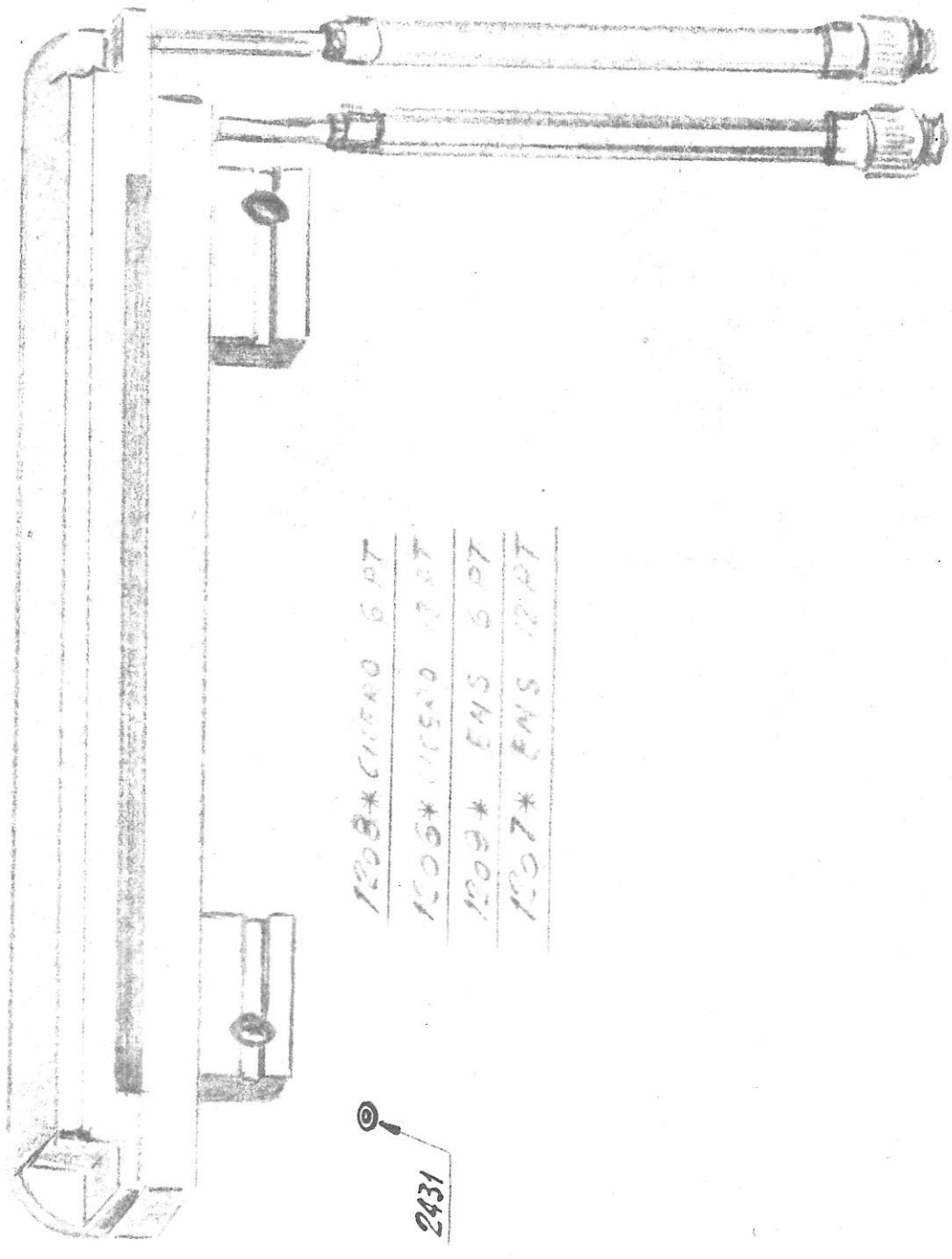

2509

- 1208\* C1160 6 PT
- 1205\* C1050 12 PT
- 1209\* F45 6 PT
- 1207\* F45 12 PT

2431

Mould - Mold



2807\* 40 CICERO  
2829\* 42 EMS

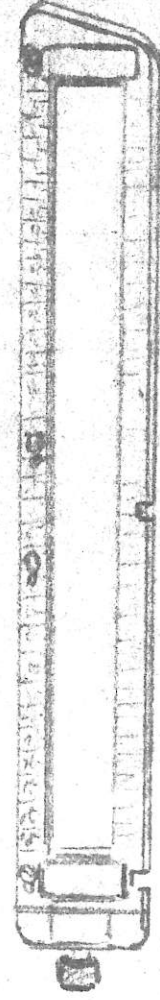

2831\* 80 CICERO  
2830\* 84 EMS



2188 80 CICERO  
2189 84 EMS



2856\* 40 CICERO  
2857\* 42 EMS

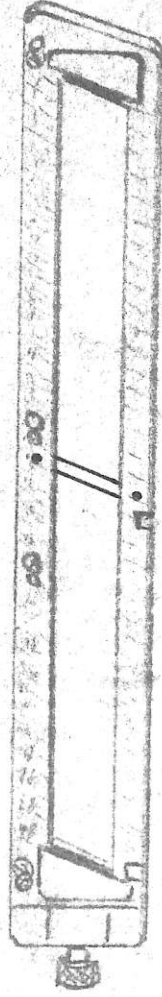

2858\* 80 CICERO  
2859\* 84 EMS



2192 80 CICERO  
2193 84 EMS



2882\*



B



2257 2670

2767 CICERO  
2768 EMS

Compositore - Composing stick

n°1 scatola contenente n.16 feltri 2098 imbibiti in olio

n. 10 tasselli distacco sfride piella

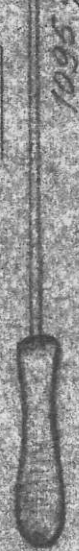

1116



Chiodi per viti con  
eragano incassato

2077

Chiave A.C. 22-24

Chiave A.C. 27

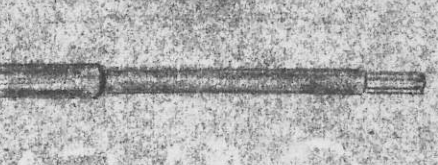
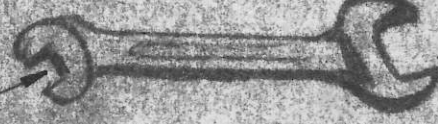

Chiave A.C. 17-19

Corredo

Tools

n.1 porta tassello distacco  
sfrido piella

2084

n. 6 viti per mould

n. 1 custodia tenuta pattino

n. 1 staffetta

2198



2197

n.2 Viti fissaggio  
avvoltoia

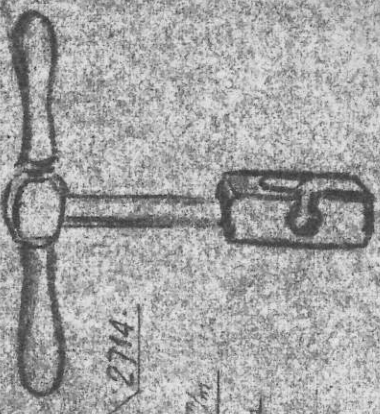

2714

1089

n°10 spine p. volante

2199

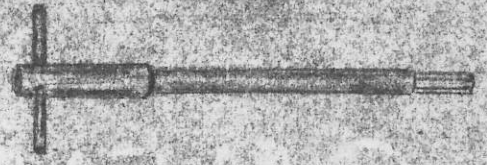

1094 - 1100 - 1093

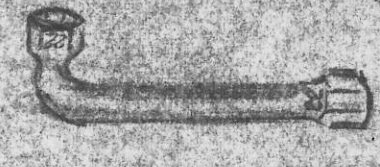

2857

Pinze a punto diritto

Pinze con punto a squadra



523

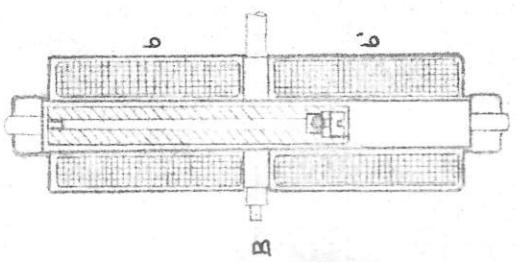

ORGANO OSCILLANTE.  
OSCILLATING ELEMENT.

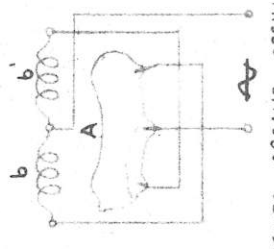

CIRCUITO ORGANO OSCILLANTE  
OSCILLATING ELEMENT CIRCUIT.

LINEA DI ALIMENTAZIONE  
SUPPLY LINE

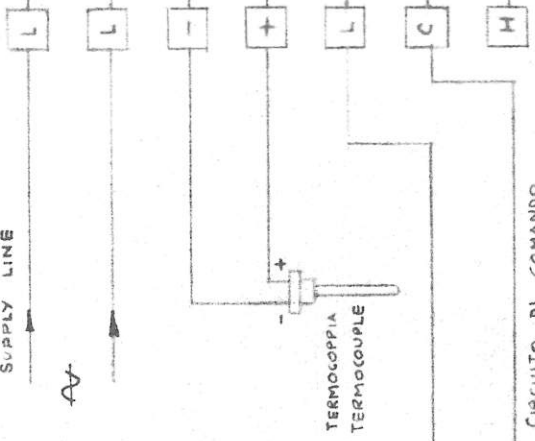

CIRCUITO DI COMANDO  
CONTROL CIRCUIT.

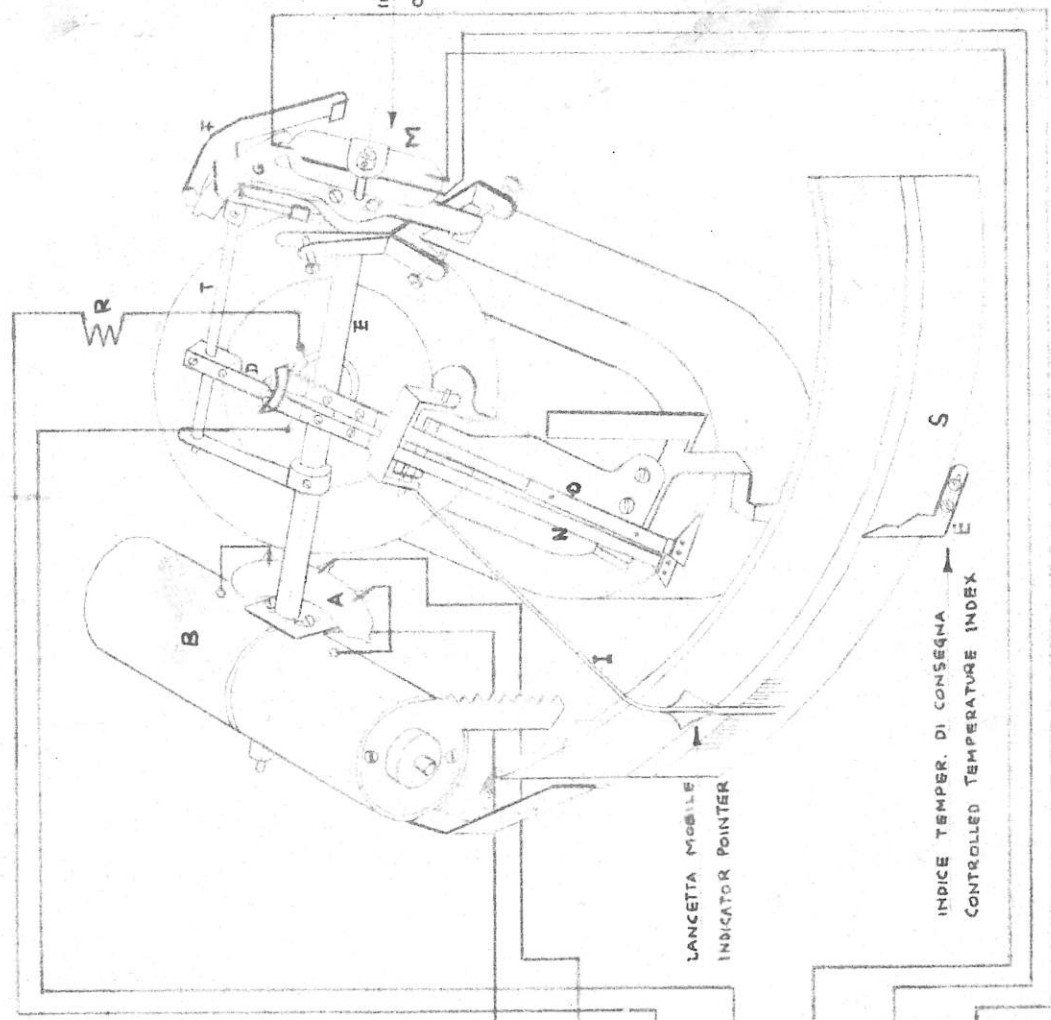

LANCETTA MOBILE  
INDICATOR POINTER

INDICE TEMPER. DI CONSEGNA  
CONTROLLED TEMPERATURE INDEX

INTERRUTTORE DI CONTROLLO  
CONTROL SWITCH

16 MAR, 1962

MATERIALE	TRATTAMENTO TERMICO	NEBITYPE	SCALA	DIS.
	FINITURA	SCHEMA REGOLATORE AUTOMAT. TEMPERATURA CROGILOLO. (SAE 172) POT TEMPERATURE CONTROLLER. (SAE 172).		VISTO
COGRAF - Milano		PEZZI	N° E - 10'023	

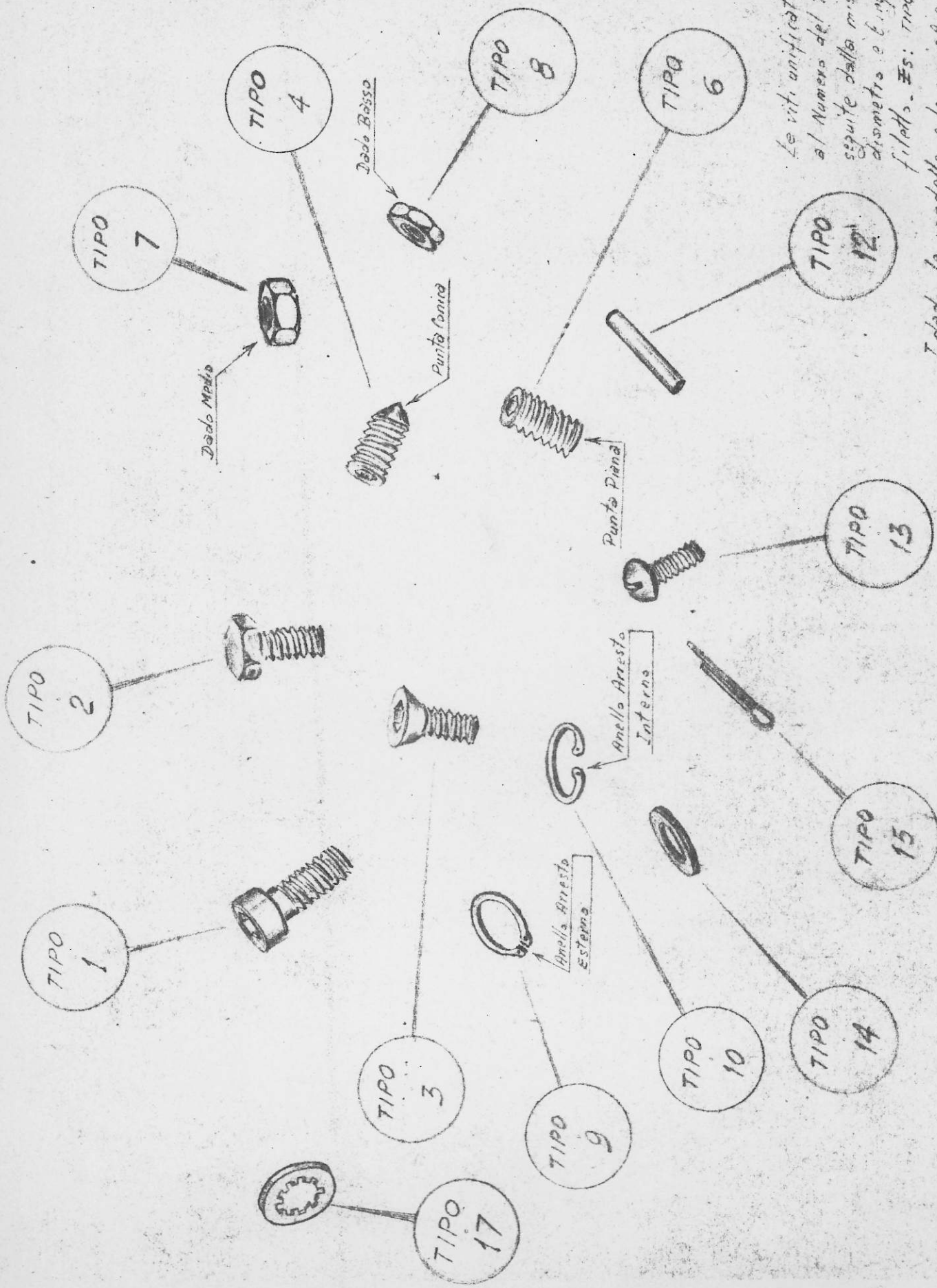

Le viti unificate oltre al Numero del TIPO sono seguite dalla misura del diametro e lunghezza del filetto. Es: tipo 1-6x15

I dadi, le rondelle e le copiglie fanno riferimento al diametro dell'assero o al filetto. Es: TIPO 7-4 TIPO 14-12 ecc.



MACCHINA A RIPOSO - FUSIONE CICLO SINGOLO  
 FUNZIONAMENTO A CICLO CONTINUO  
 RIGHE BIANCHE 12 PT

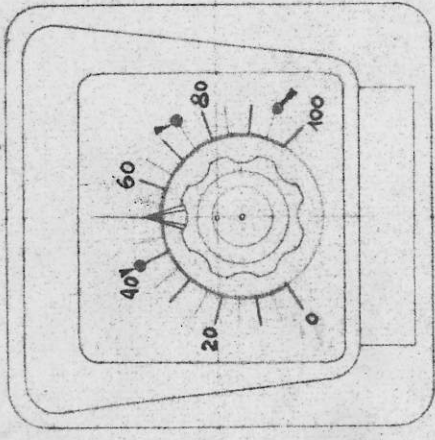

CICLO CONTINUO  
 RIGHE BIANCHE 6 PT

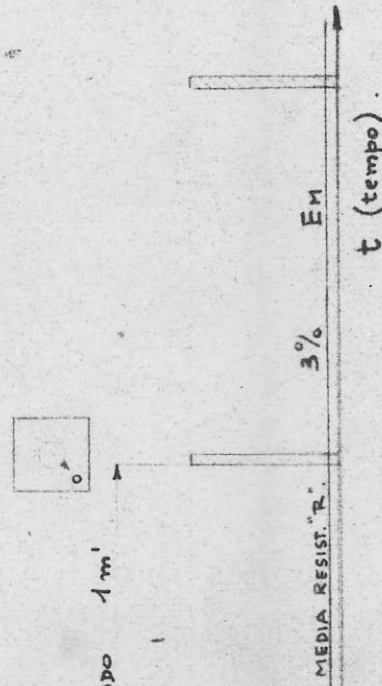
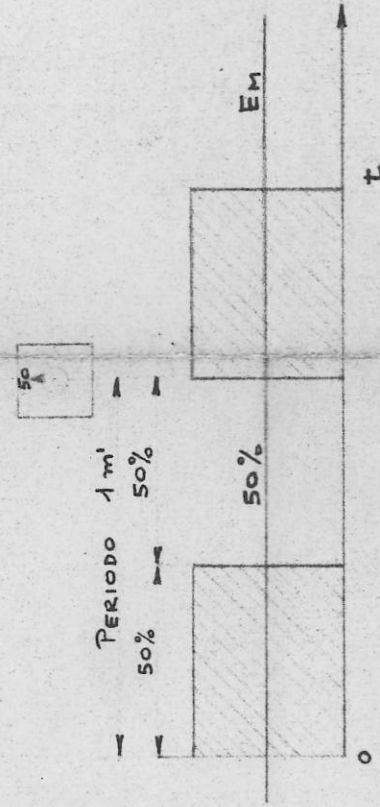
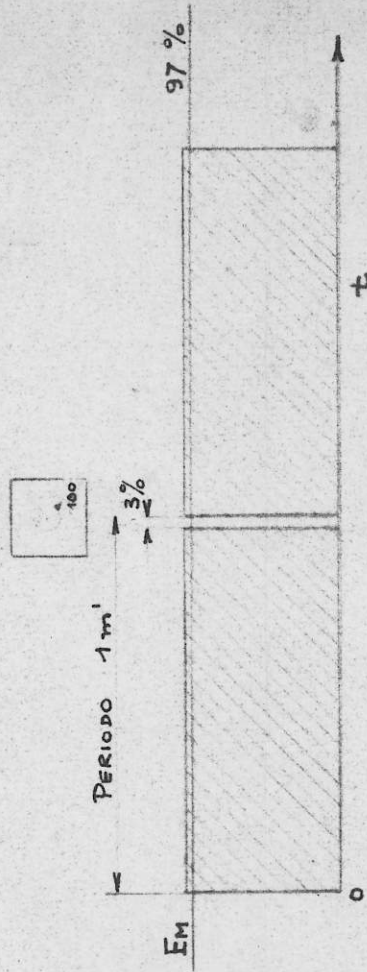
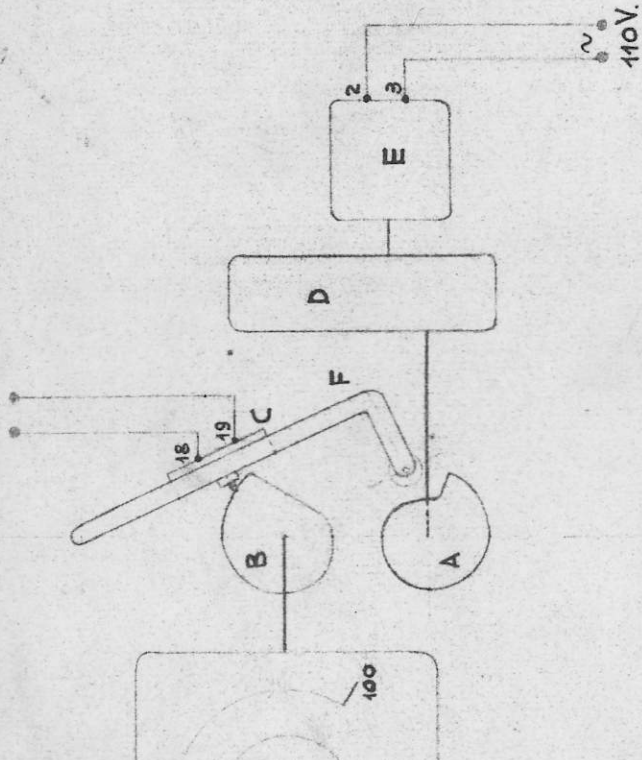
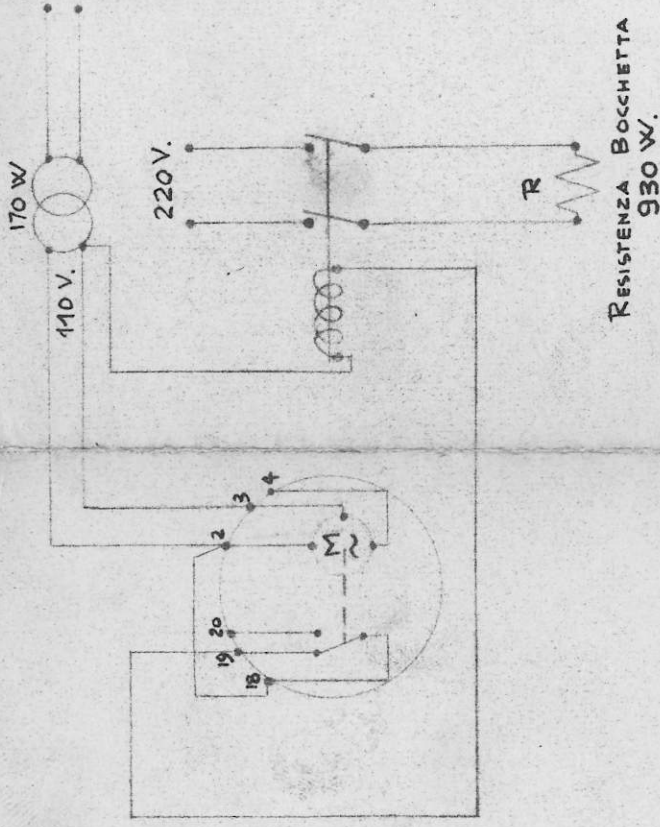

CARATTERISTICHE:

ALIMENTAZIONE : TENSIONE : 110-220V - FREQUENZA : 50 (o 60) Hz - CONSUMO : 3 WATT.

UTILIZZAZIONE : CORRENTE : 10 AMP - TENSIONE : 110V. ( 5AMP - 220V. )

REGOLAZIONE MINIMA : 3% DELLA DURATA CICLO.

REGOLAZIONE MASSIMA : 97% DELLA DURATA CICLO.

DURATA DEL CICLO : 1 m'.

O : LA CAMMA "A" RUOTA IN CONTINUAZIONE ALLA VELOCITA' DI 1 GIRO/M'

MOTORE SINCRONO "E" E DEL RIDUTTORE "D", E PROVOCA L'OSCILLAZIONE

"C" CHE CONTIENE IL MICROINTERRUTTORE "C".

DELLE OSCILLAZIONI IL BOTTONE DEL MICROINTERRUTTORE "C" VIENE

COMANDATO DA UNA SECONDA CAMMA "B" COMANDATA DALLA MANOPOLA

POSTA SUL QUADRANTE DELLO STRUMENTO.

DELLE OSCILLAZIONI DEL MICROINTERRUTTORE E QUINDI IL TEMPO

DELLO STESSO, DIPENDONO DALLA POSIZIONE DELLA CAMMA "B".